

# CAMOPLAST MOUNTING KIT, SPMN



P/N 2879497

## Application

SPORTSMAN 500/600/700/800 MY05-14

Before you begin, read these instructions and check to be sure all parts and tools are accounted for. Please retain these installation instructions for future reference and parts ordering information.

## FRONT ANCHOR BRACKET:

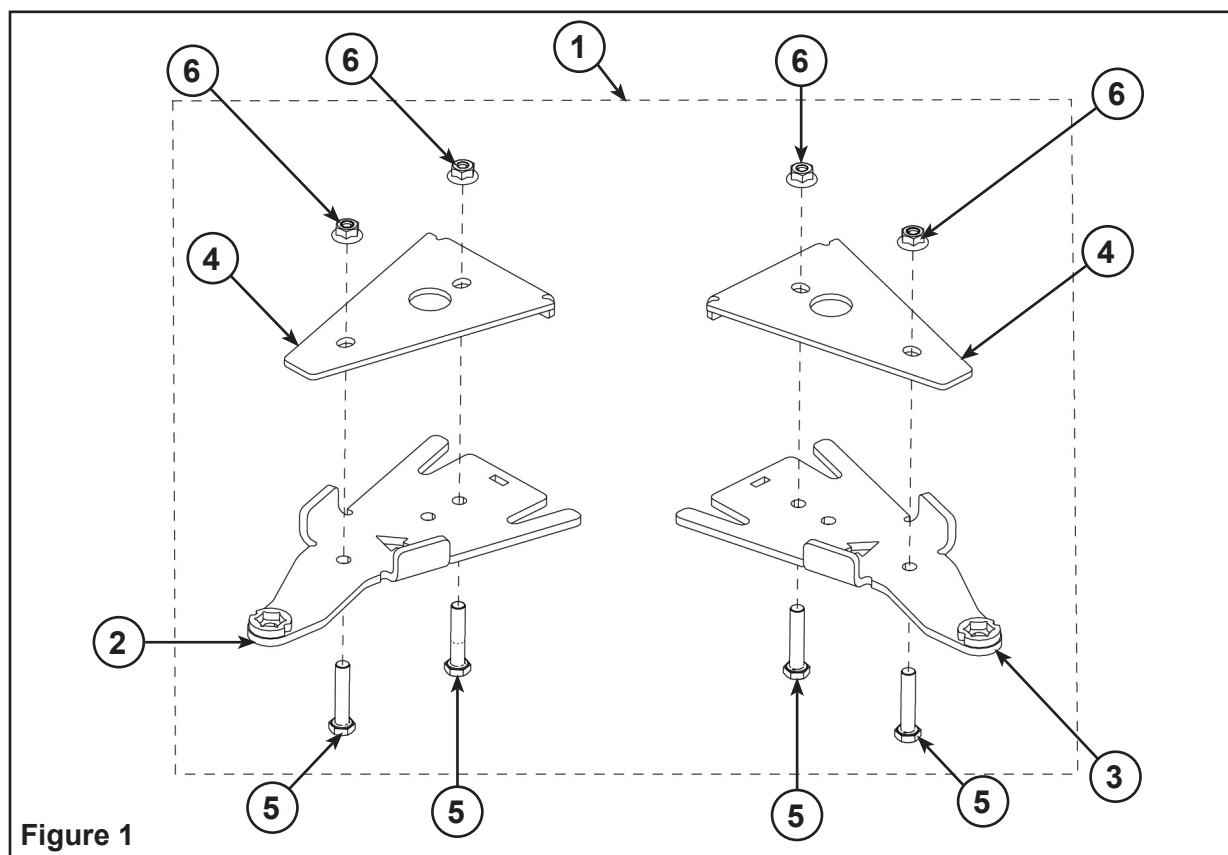

## Kit Contents:

<u>Ref</u>	<u>Qty</u>	<u>Part Description</u>	<u>Part Number</u>
1	1	Front Bracket Kit	2205408
2	1	Front Left Anchor Bracket	-
3	1	Front Right Anchor Bracket	-
4	2	Front Bracket Cover	-
5	4	Hex Bolt-HCS, M10-1.5X50, 8.8, ZP, DIN931	-
6	4	Nylon Nut-FNN, M10-1.5, 8, ZP, DIN6926	-

## REAR ANCHOR BRACKET:

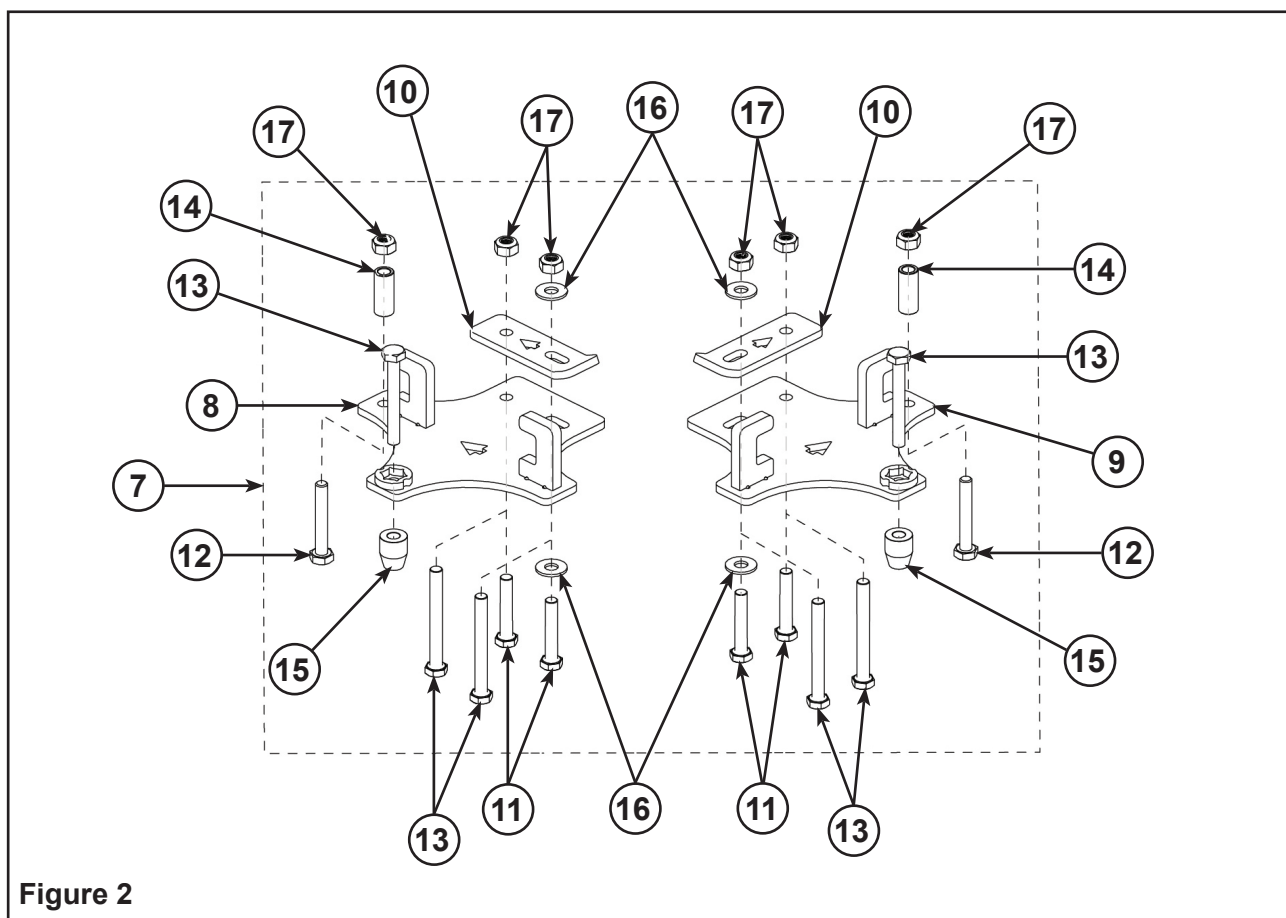

### Kit Contents:

<u>Ref</u>	<u>Qty</u>	<u>Part Description</u>	<u>Part Number</u>
7	1	Rear Bracket Kit	2205409
8	1	Rear Left Anchor Bracket	-
9	1	Rear Right Anchor Bracket	-
10	2	Rear Bracket Cover	-
11	4	Hex Bolt-HCS, M10-1.5X55, 8.8, ZP, DIN931	-
12	2	Hex Bolt-HCS, M10-1.5X65, 8.8, ZP, DIN931	-
13	6	Hex Bolt-HCS, M10-1.5X80, 10.9, ZP, DIN931	-
14	2	Bushing-0,390ID X 0,625OD X 1,500L	-
15	2	Bushing-0,406ID X 0,875OD X 1,100L, YZN	-
16	4	Washer-7/16X1.0X0.072, 8, ZP, USS	-
17	6	Nylon Nut-FNN, M10-1.5, 8, ZP, DIN6926	-

WHEEL LUG NUT:

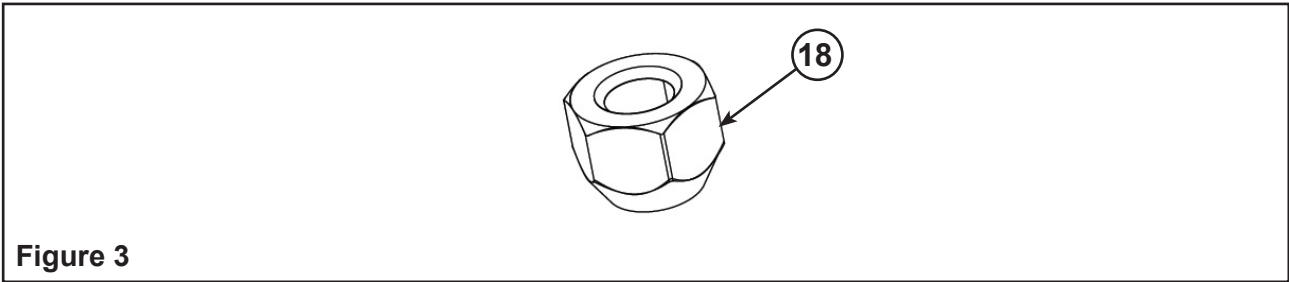

Kit Contents:

<u>Ref</u>	<u>Qty</u>	<u>Part Description</u>	<u>Part Number</u>
18	16	Wheel Lug Nut-LN, 3/8"x 24 Tapered	2205457
	1	Instructions	9924982

Tools Required:

**APPROXIMATE ASSEMBLY TIME:** 60 minutes

**IMPORTANT:** Please read carefully each part of this document as well as the User Manual prior to assembling, installing and using the track systems.

INSTALLATION INSTRUCTIONS:

**CAUTION:** Before beginning the installation, make sure you received all the components included in the parts lists of the preceding pages.

1. For installation purposes, directional arrows have been cut out of the main components in the anchor bracket kits. These arrows indicate the front of the vehicle relative to the component. Figure 4.

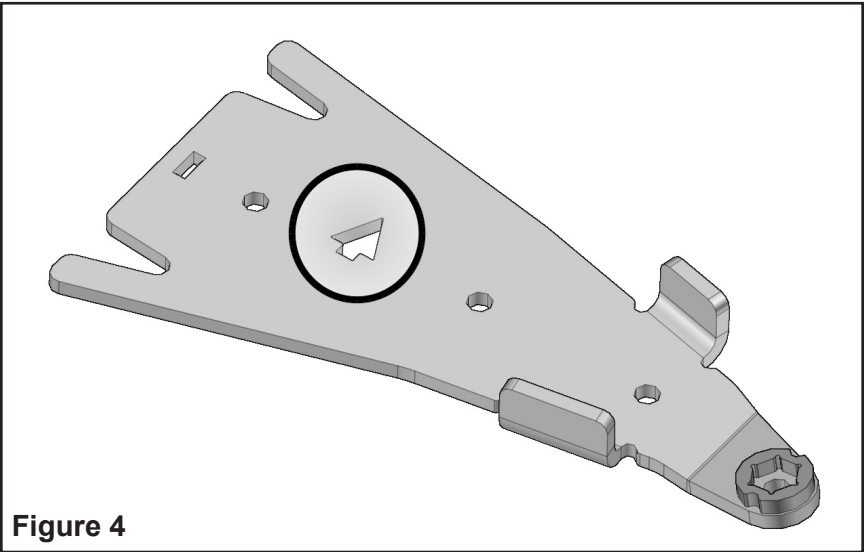

## PREPARATION:

**WARNING:** Never place body parts under the vehicle unless it is securely placed on appropriate stands. Severe injuries could occur if the vehicle collapses or moves. Do not use a lifting device as a secure stand.

1. Position the vehicle on a flat and level surface (or on a suitable lifting device), shift the transmission to neutral and turn off engine.
2. Identify and position each unit of the track system near the position indicated on the sticker. Figure 5.

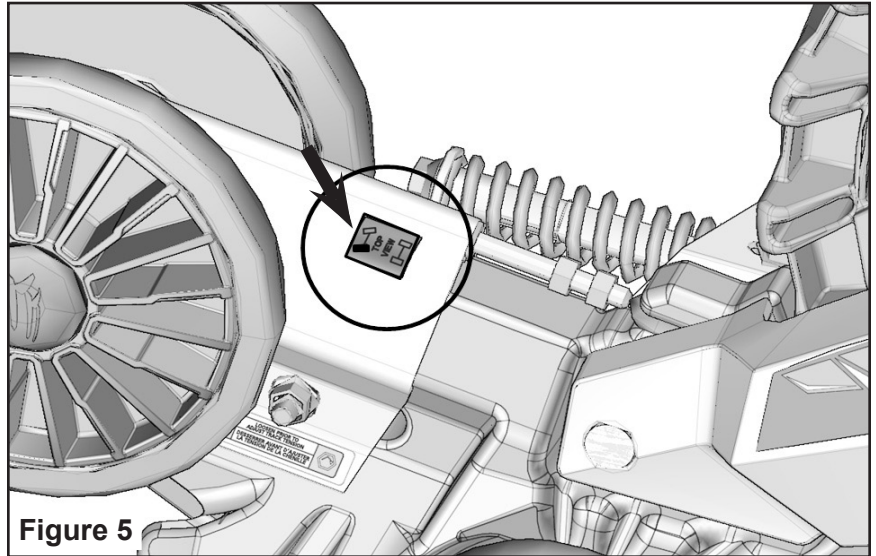

## REAR TRACK SYSTEMS:

1. Using a lifting device, raise the rear of the ATV and install appropriate stands. Ensure that the vehicle is immobilized and safe to work on.
2. Remove rear wheels. Make sure that wheel studs and wheel hubs are free of dirt. Figure 6.

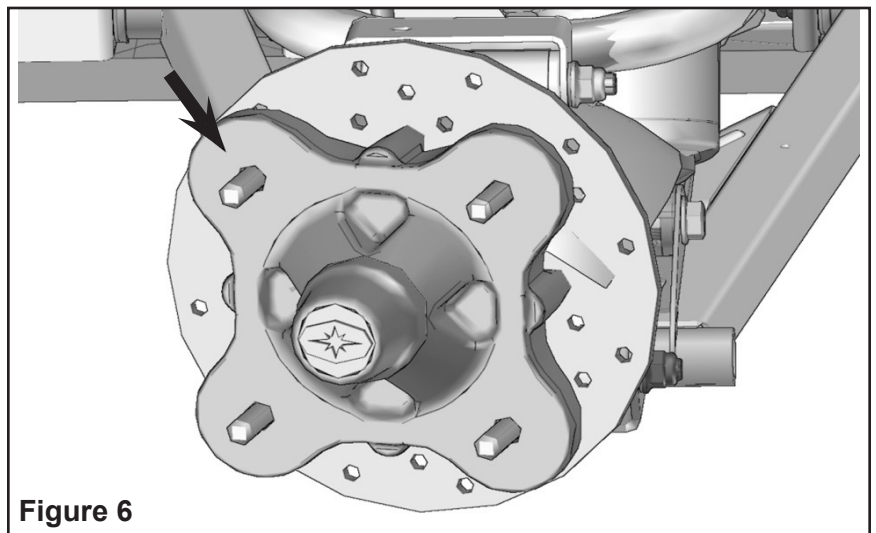

3. If applicable, remove the CV joint protectors from the lower A-arm.
4. Remove bolt, washer and spacer bushings from the rear stabilizing rod end. Discard the M10x60 mm bolt and one of the spacer bushings from the disassembled set of parts of each stabilizing rod. Figure 7. Insert a M10x80 mm bolt provided in the parts kit in each bracket end. Figure 7a.

**NOTE:** It is not possible to insert this bolt once the bracket is attached to the suspension arm.

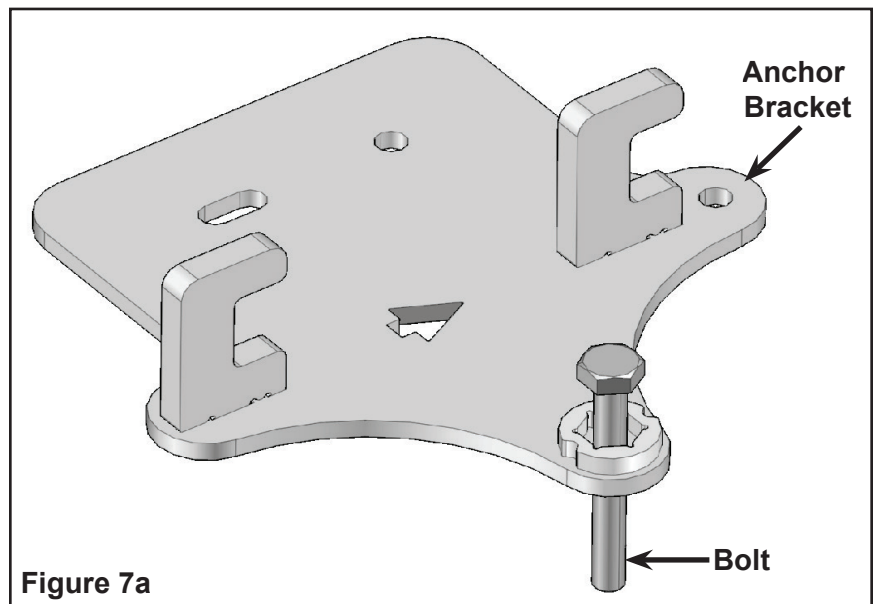
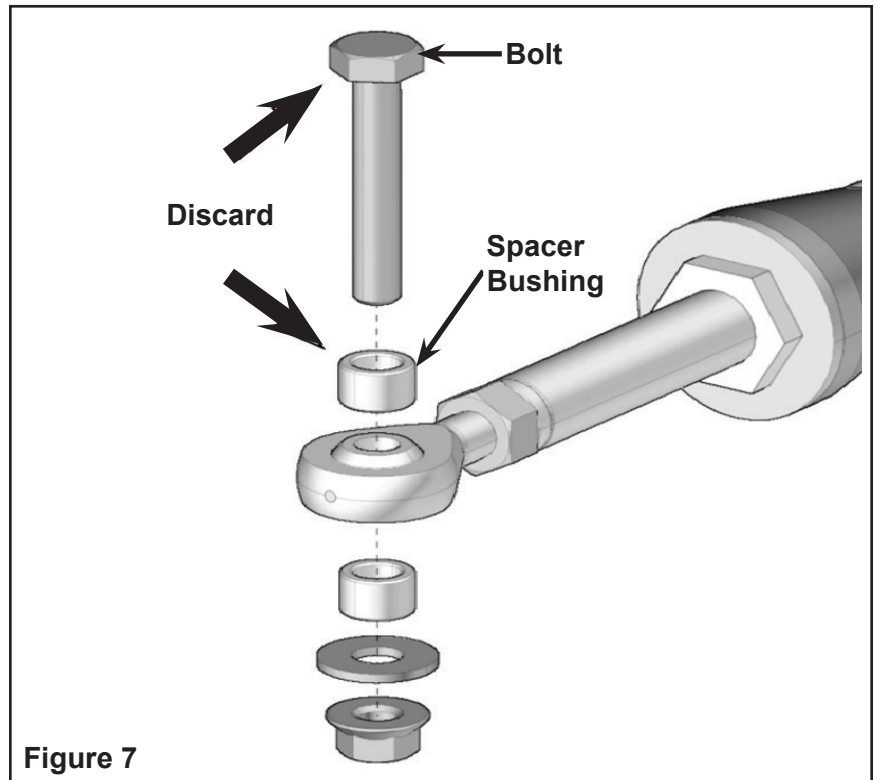

5. Position anchor bracket under the lower suspension arm; C-shaped openings on bracket must be located on suspension arm tubes. Figure 8. Insert the M10x65 mm bolt in the bracket hole aligned with c-shaped hooks, install spacer bushing and nut on bolt. Tighten assembly to 37 ft. lbs. (50 Nm) of torque. Figure 8a.

**NOTE:** Arrow cutout in anchor bracket must face front of vehicle.

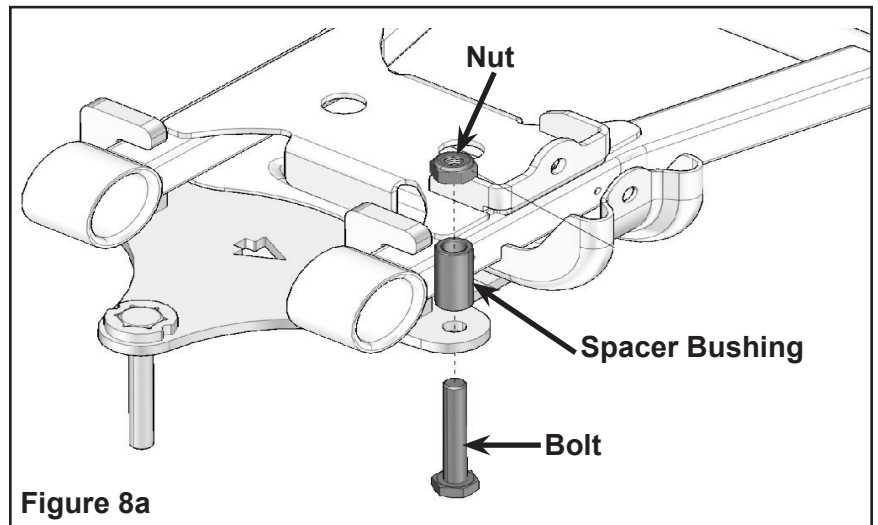
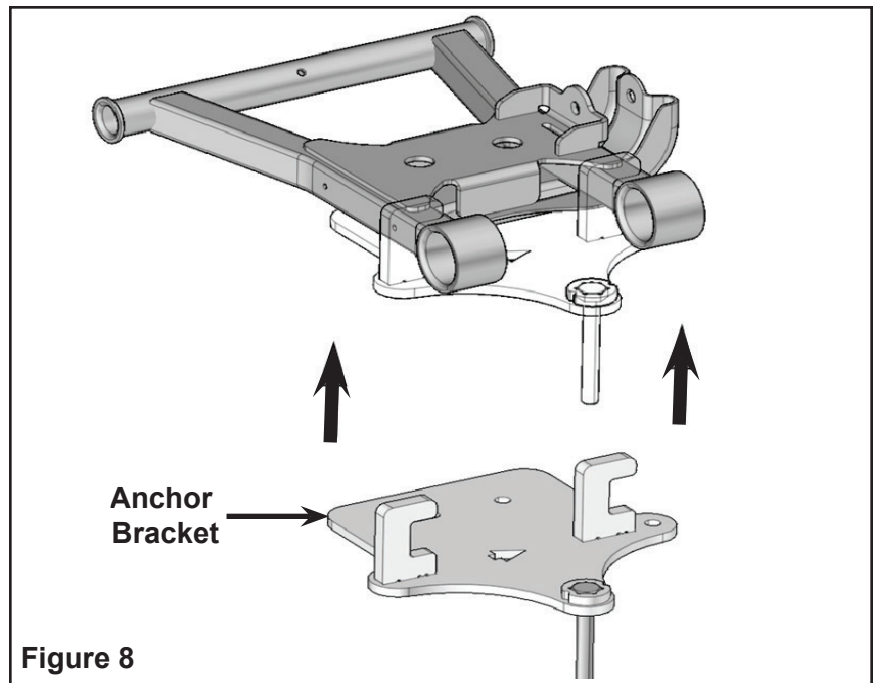



6. Position the bracket cover over lower suspension arm. Insert appropriate bolts (M10x55 mm or M10x80 mm) through bottom washers must be placed under head of bolt and nut installed in oblong holes of bracket plate and cover. Use nuts to tighten assembly to 37 ft. lbs. (50 Nm) of torque. Figure 9 and Figure 9a.

**NOTE:** Arrow cutout in anchor bracket must face front of vehicle.

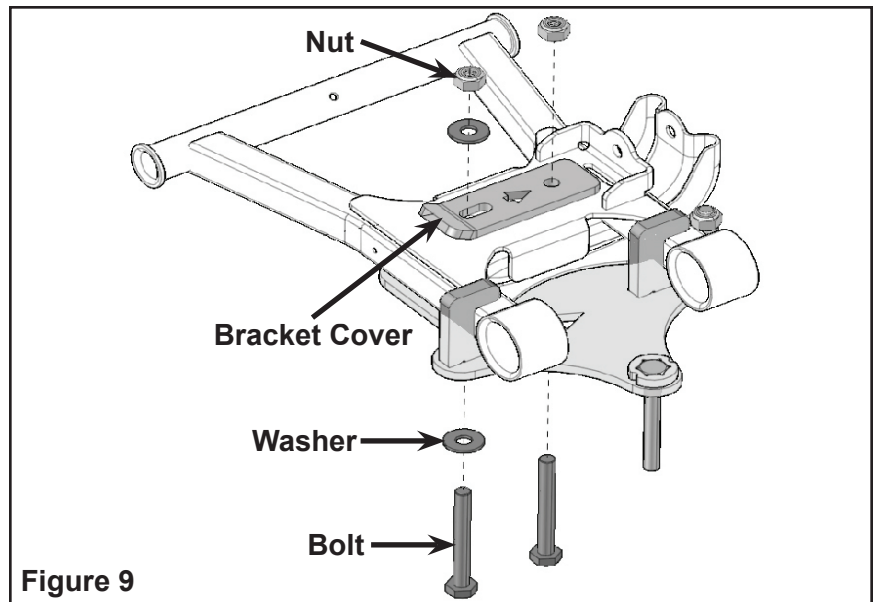

Figure 9

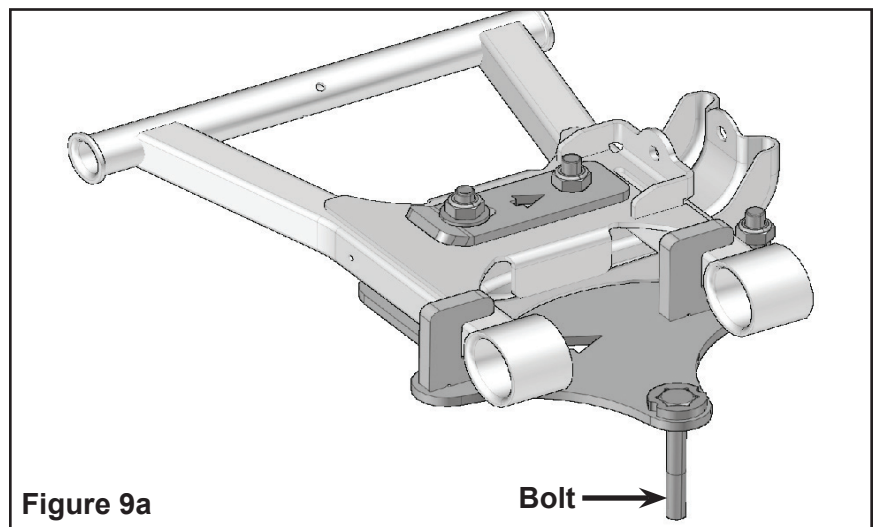

Figure 9a

7. Secure the undercarriage to the rear hub using the nuts provided in the mount kit. Figure 10.

**NOTE:** If needed, take rubber protector off of hub.

**NOTE:** Ensure that the cotter pin of the axle nut does not interfere with the undercarriage hub.

**NOTE:** Use the torque specified by the ATV manufacturer when tightening wheel nuts.

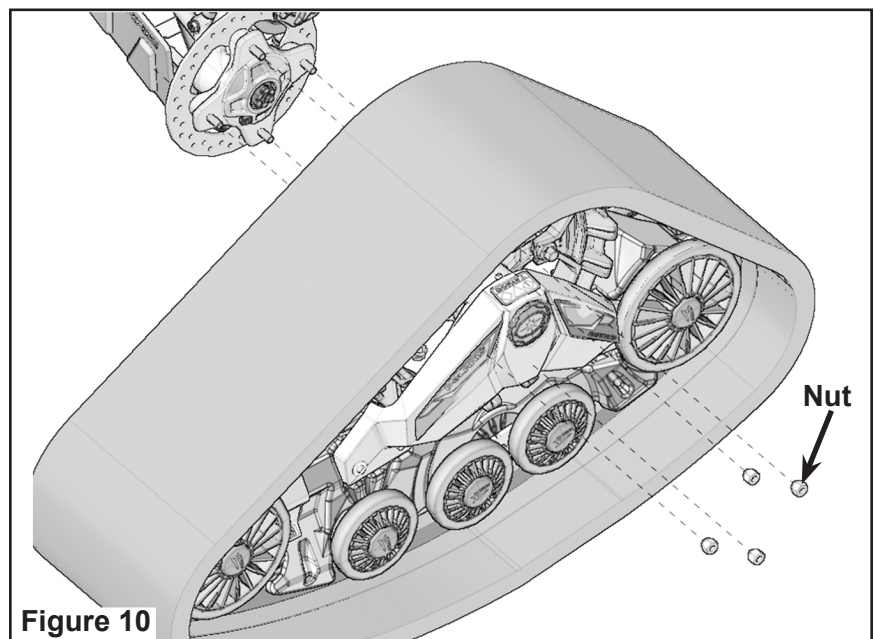
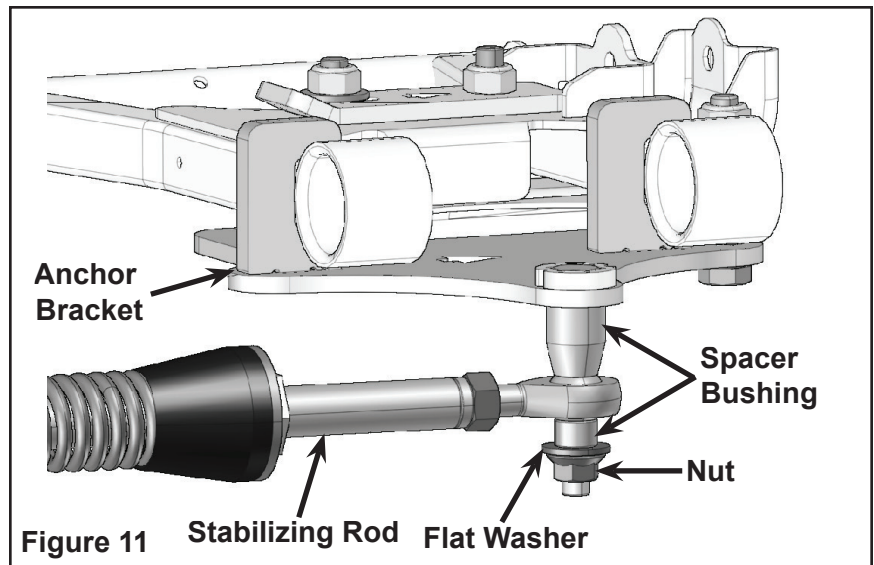

Figure 10

8. Attach the stabilizing rod to the anchor bracket, using the long spacer bushing provided in the mount kit, the short spacer bushing, the flat washer and nut. Torque to 52 ft. lbs. (70 Nm). Figure 11.

**NOTE:** Ensure that parts are assembled in the correct order.

9. Inspect the rear track systems and ensure that all mounting bolts were correctly tightened during installation. Lower the ATV to the ground and install the front track systems on the ATV.



## FRONT TRACK SYSTEMS:

1. Using a lifting device, raise the front of the UTV and install appropriate stands. Ensure that the vehicle is immobilized and safe to work on.
2. Remove front wheels. Make sure that wheel studs and wheel hubs are free of dirt. Figure 12.

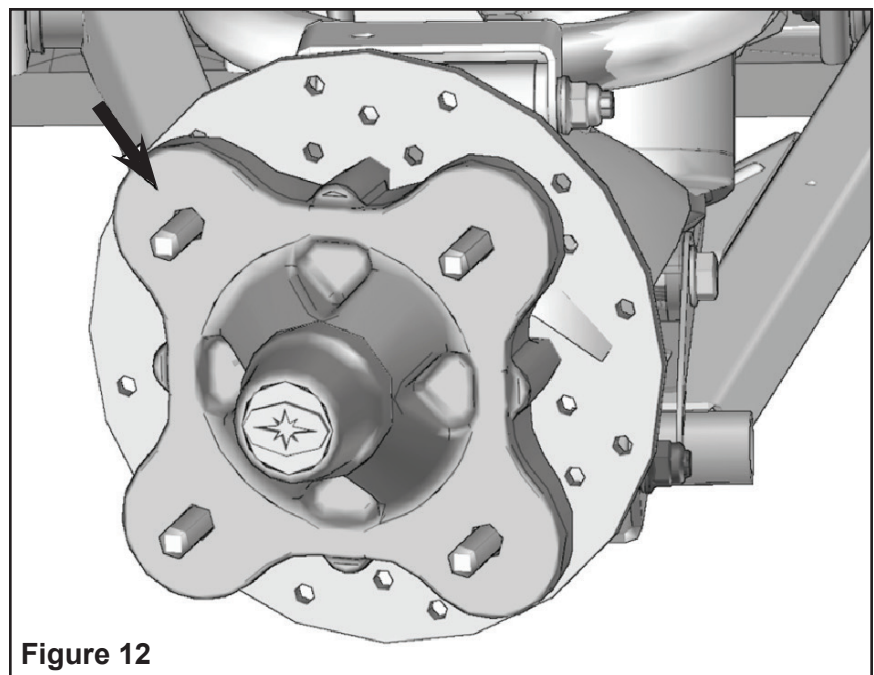



3. If applicable, remove the CV joint protectors from the A-arms.
4. Remove the bolt, washer and bushings from the front stabilizing rod end. Figure 13.  
Insert the bolt in the front anchor bracket. Figure 13a.

**NOTE:** It is not possible to insert this bolt once the bracket is attached to the suspension arm.

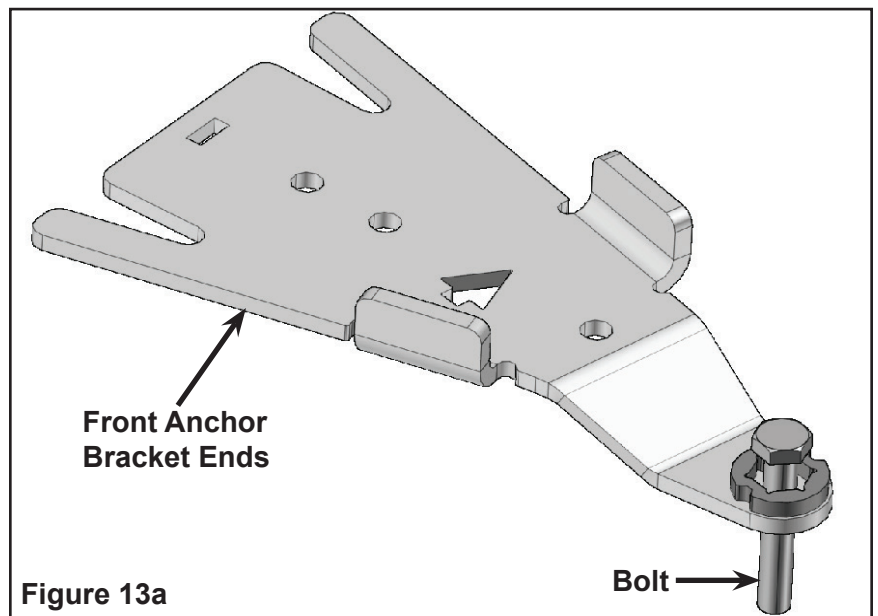
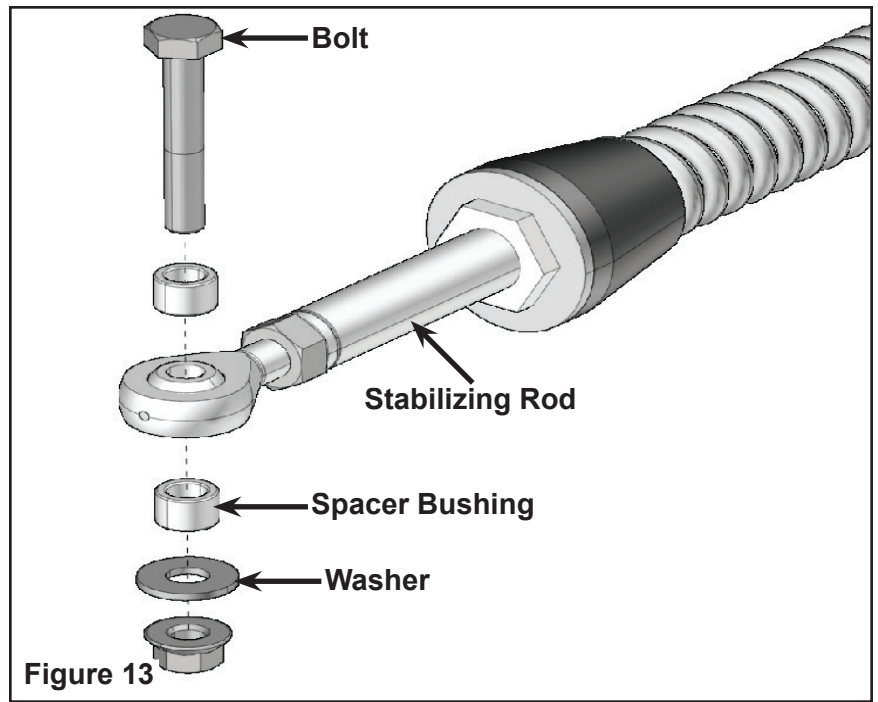

5. Position the bottom part of the anchor bracket underneath the lower suspension arm. Position the top part over the suspension arm so the tab slips in the slot in the bottom part. Figure 14.

Insert the M10X55 mm bolts through the bottom and secure the two parts together with the nuts provided. Torque the assembly to 37 ft. lbs. (50 Nm). Figure 14a. and Figure 15.

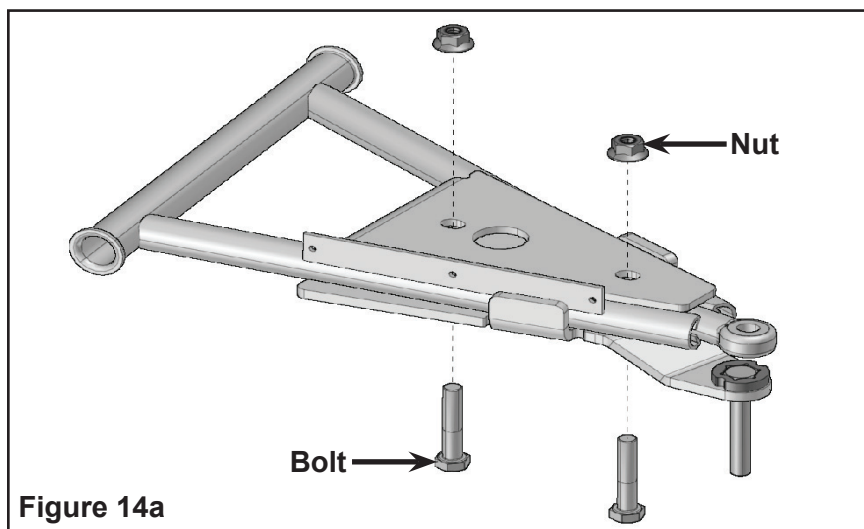
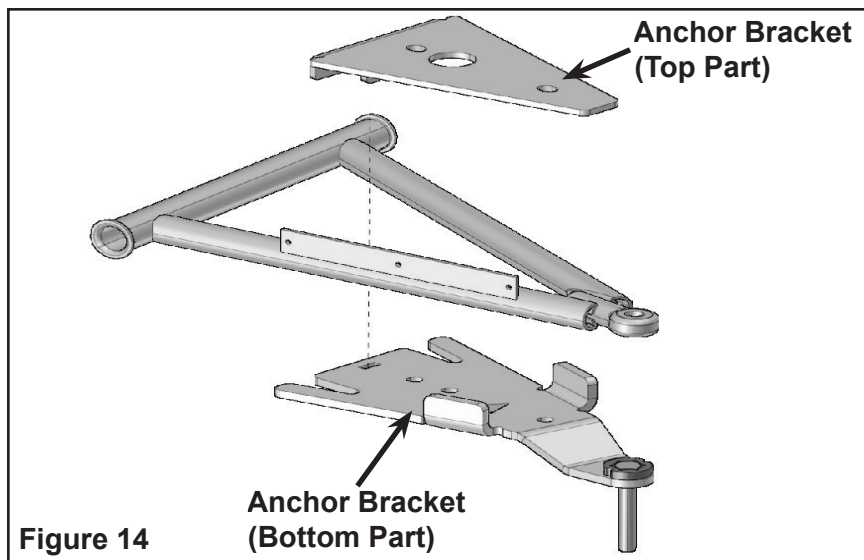

6. Secure the undercarriage to the front hub using the nuts provided in the mount kit. Figure 10.

**NOTE:** If needed, take rubber protector off of hub.

**NOTE:** Ensure that the cotter pin of the axle nut does not interfere with the undercarriage hub.

**NOTE:** Use the torque specified by the ATV manufacturer when tightening wheel nuts.

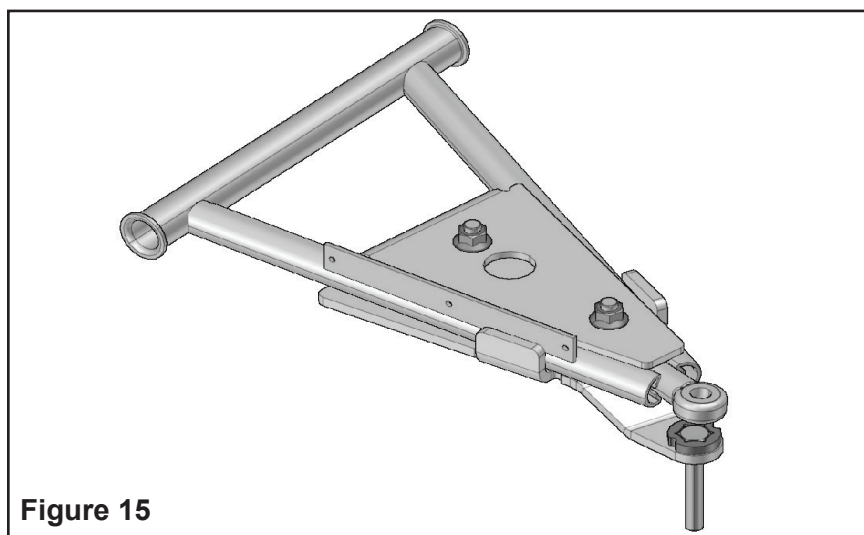

7. Attach the stabilizing rod to the anchor bracket, using the two spacer bushings, flat washer and nut. Torque to 52 ft. lbs. (70 Nm). Figure 16.

**NOTE:** Ensure that parts are assembled in the correct order.

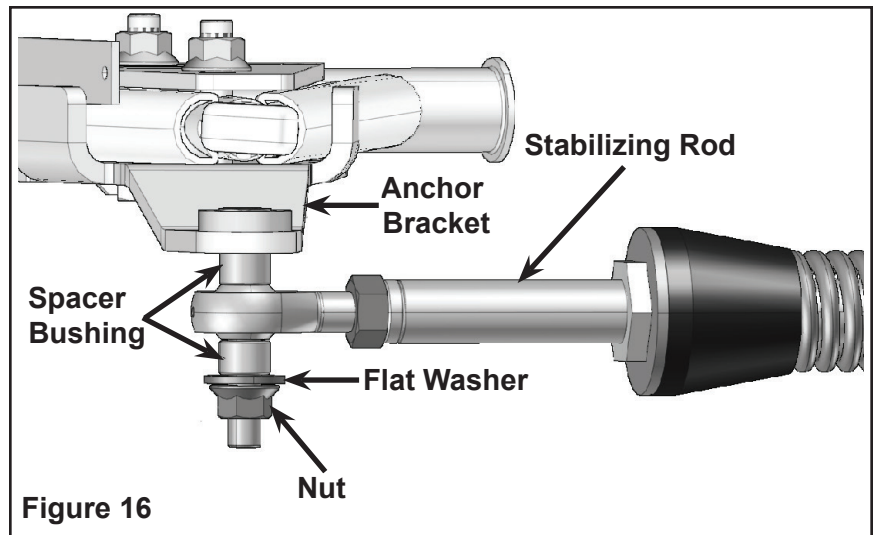

### COMPLETION:

1. Verify the suspension settings. If the shock absorbers are adjustable, they should be adjusted to the firmest level in order to allow for maximum clearance between the system and the fender of the vehicle.
2. Verify for possible contact between the undercarriage and the lower fender. If there is contact, the fender should be modified (cut) to avoid damage to the vehicle's components and premature wear on rubber track.
3. Lower the ATV to the ground.

### ADJUSTMENTS:

**CAUTION:** The track systems are designed to provide the best performance in terms of traction and floatability. Adjustments such alignment, track tension, and angle of attack are necessary and mandatory for optimal performance of the systems. For more information on these adjustments, refer to the **ADJUSTMENT RECOMMENDATIONS** or **USER MANUAL** provided with the installation kit specific to the vehicle.