

PASSENGER FOOTREST KIT



P/N 2882797

APPLICATION

Verify accessory fitment at Polaris.com

BEFORE YOU BEGIN

Read these instructions and check to be sure all parts and tools are accounted for. Please retain these installation instructions for future reference and parts ordering information.

KIT CONTENTS

This Kit includes:

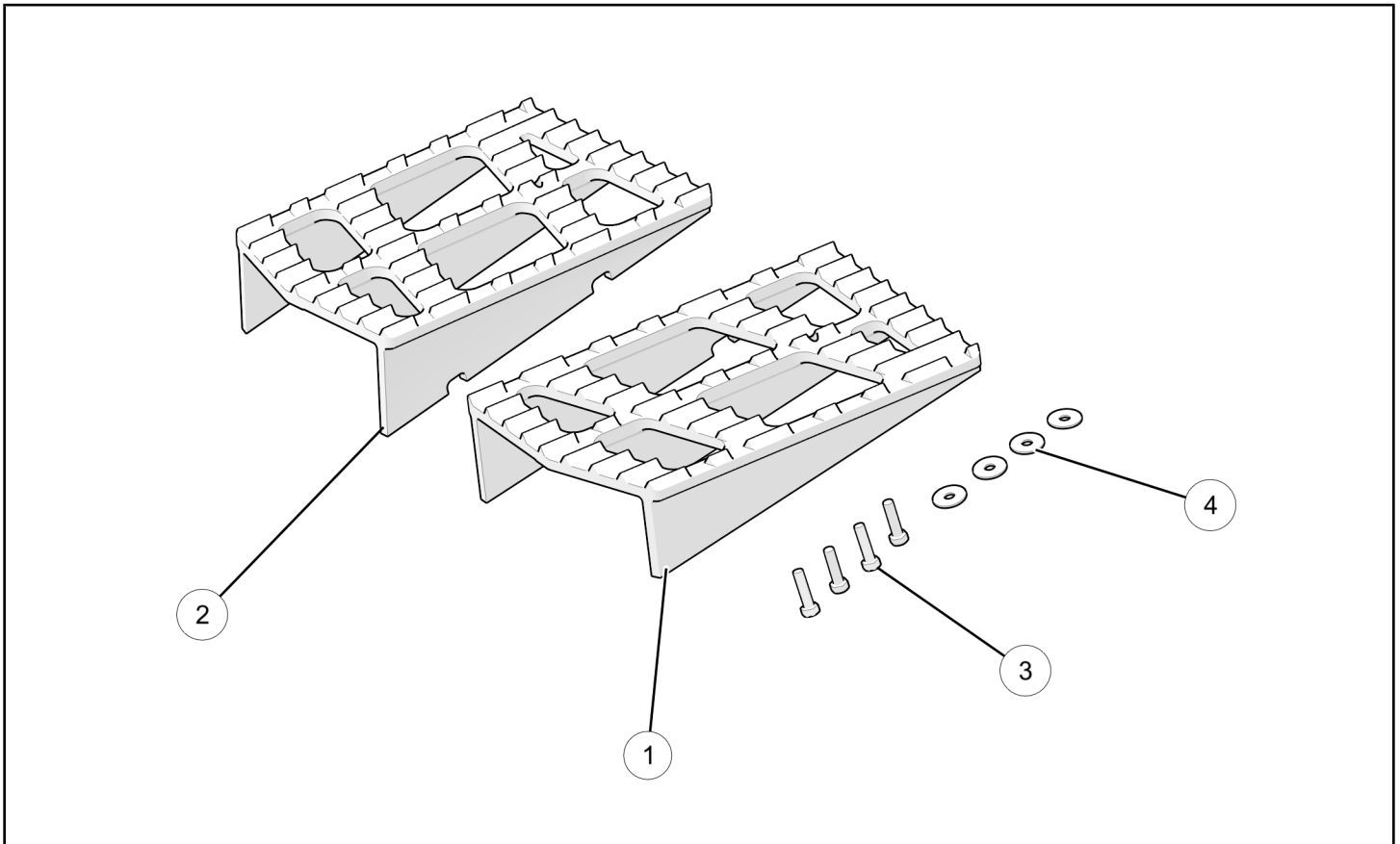

REF	QTY	PART DESCRIPTION	PART NUMBER
1	1	Footrest, Passenger, LH	5141288
2	1	Footrest, Passenger, RH	5141289
3	4	Screw-M5X.80X20-HX/FL	7516607
4	4	Washer-.20X.67X.048-M	7556034
	1	Instructions	9927950

TOOLS REQUIRED

- Safety Glasses
- Drill
- Drill Bit: 3/16" (5mm)
- Socket Set, Metric
- Torque Wrench

IMPORTANT

Your PASSENGER FOOTREST KIT is exclusively designed for your vehicle. Please read the installation instructions thoroughly before beginning. Installation is easier if the vehicle is clean and free of debris. For your safety, and to ensure a satisfactory installation, perform all installation steps correctly in the sequence shown.

ASSEMBLY TIME

Approximately 18 minutes

INSTALLATION INSTRUCTIONS

1. If your vehicle is equipped with closeout panels **A** you will need to remove the two rivets **B** shown below from the underside of each running board to allow for the installation of the passenger footrests. If your vehicle is not equipped with closeout plates move on to the next step.

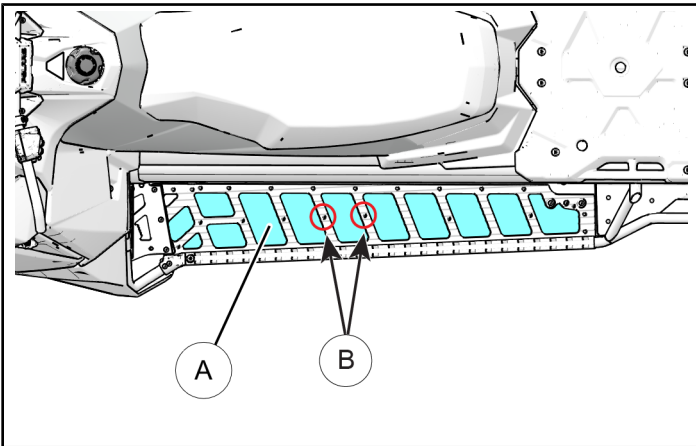

2. Place the passenger footrest **1** on the running board, line up the mounting holes as shown with the holes that are indicated in the previous step for rivet removal and attach using the provided screws **2** and washers **3**. Torque to specification.

NOTE

If your vehicle is not equipped with closeout panels no washers are required.

FEEDBACK FORM

A feedback form has been created for the installer to provide any comments, questions or concerns about the installation instructions. The form is viewable on mobile devices by scanning the QR code or by clicking [HERE](#) if viewing on a PC.

FEEDBACK FORM



TORQUE

65 in/lbs (7.3 Nm)

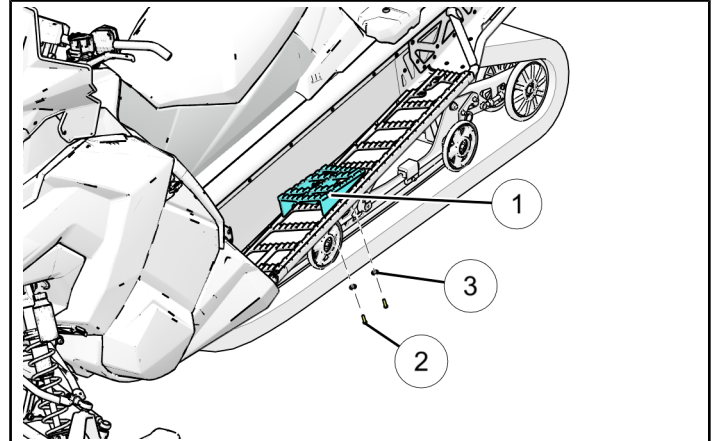

3. Repeat the above steps for the opposite side.