

X2 SEAT BACKREST KIT



P/N 2880377

APPLICATION

AXYS SWITCHBACK WITH CARGO RACK (P/N 2880205/2880205-458) AND AXYS X2 SEAT (P/N 2280378)

BEFORE YOU BEGIN

Read these instructions thoroughly and make sure all parts and tools are accounted for. Please retain these installation instructions for future reference and parts ordering information.

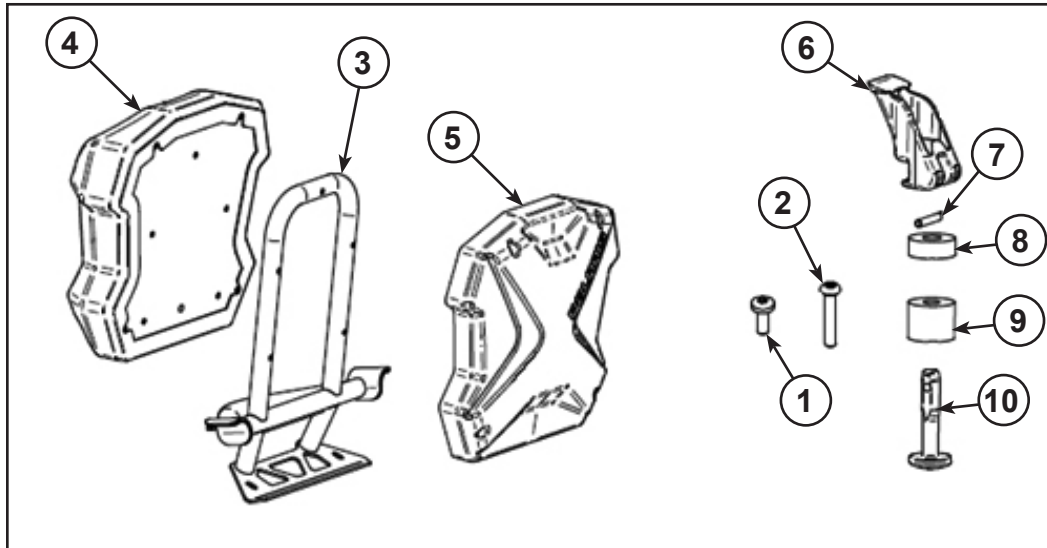

KIT CONTENTS

Ref	Qty	Part Description	Part Number
1*	4	Button Head Torx Cap Screw Black Zp M6-1.0 X 16mm	
2*	5	Button Head Torx Cap Screw Black Zp M6-1.0 X 35mm	
3	1	Backrest Frame	
4	1	Backrest Cushion	
5	1	Backrest Cover	
6*	2	Lock And Ride Handle	
7*	2	Lock And Ride Pin	
8*	2	Lock And Ride Spacer	
9*	2	Lock And Ride Bushing	
10*	2	Lock And Ride Shaft	
	1	Instructions	9925573

ITEMS MARKED (*) ARE INCLUDED IN THE HARDWARE KIT PN 2206087.

TOOLS NEEDED

Torx Wrench Set

Safety glasses

APPROXIMATE ASSEMBLY TIME

10 mins

IMPORTANT

Your Polaris X2 SEAT BACKREST KIT is exclusively designed for your vehicle. Please read the installation instructions thoroughly before beginning. Installation is easier if the vehicle is clean and free of debris. For your safety, and to ensure a satisfactory installation, perform all installation steps correctly in the sequence shown.

INSTALLATION INSTRUCTIONS

1. Park the vehicle. Turn the key "OFF" position and remove from the vehicle.
2. Install the backrest cushion (4) on the backrest frame (3) using five M6x35 mm screws (2). Backrest cushion (4) must be installed on the front side of frame (3) as shown in figure.

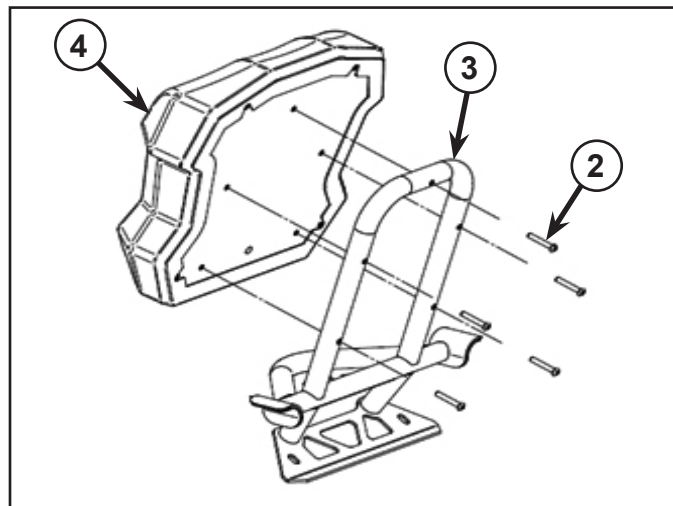

3. Install the backrest cover (5) using four M6x16 mm screws (1) on the backside of the backrest cushion (4) as shown in figure.

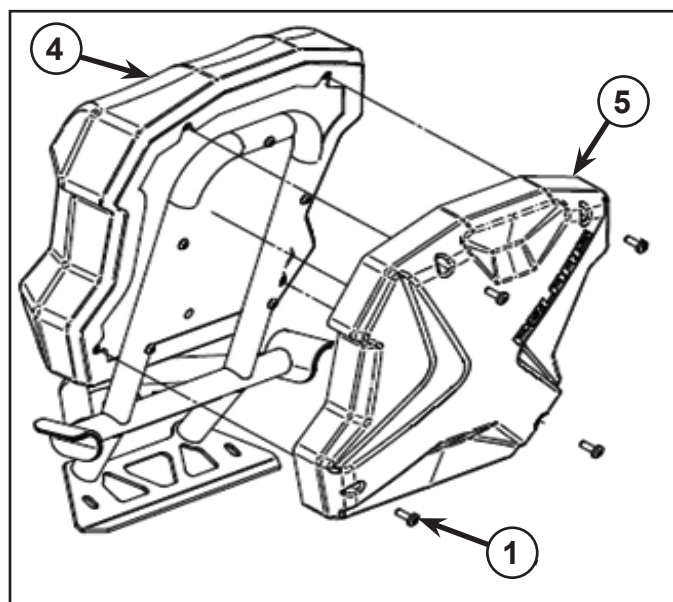

4. Install Lock and Ride shaft (10) with bushing (9) and spacer (8) as shown in figure.

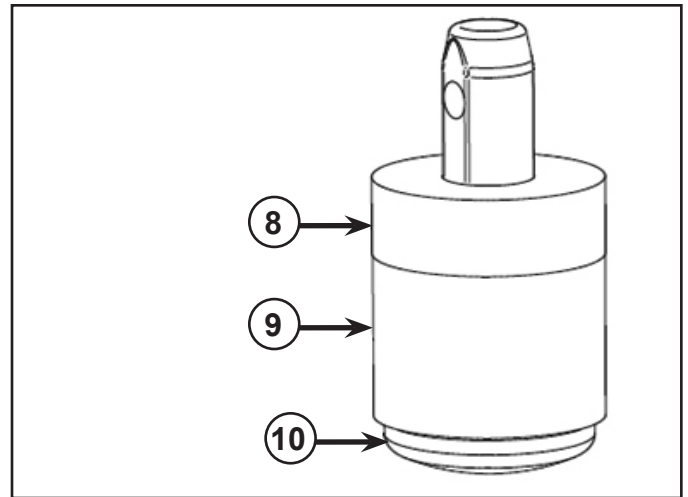

5. Slide the Lock and Ride shaft, bushing and spacer in each of two holes of the backrest frame (3) as shown in figure.

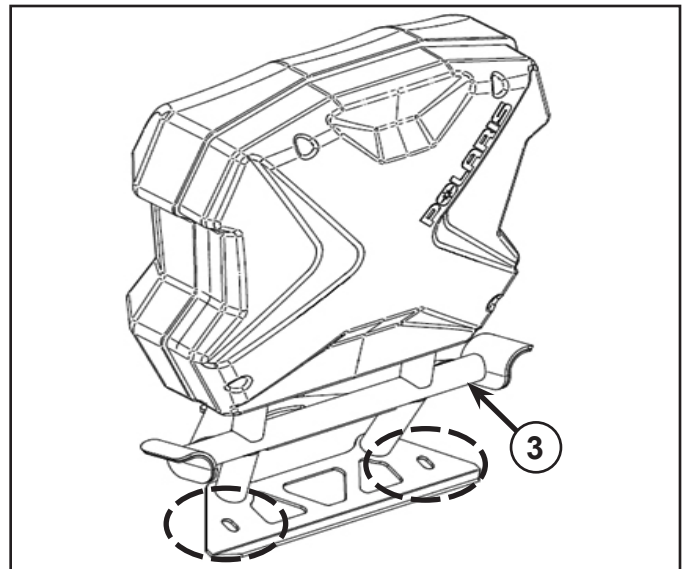

6. Install pin (7) through shaft (10) as shown in figure.

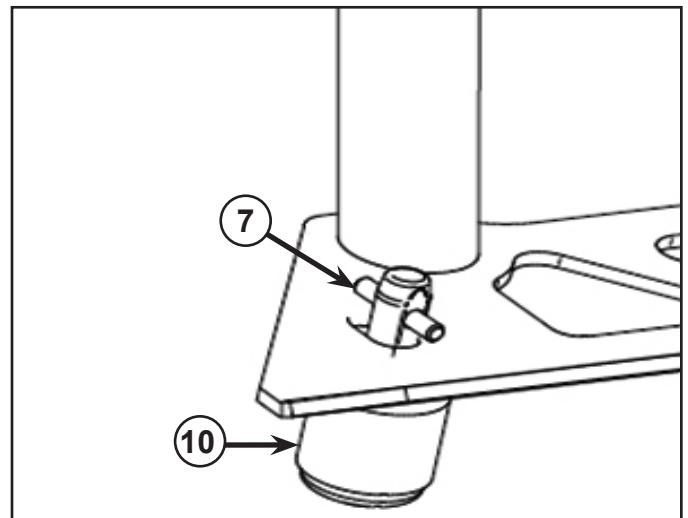

7. Slide handle (6) onto the pin (7) as shown in figures.

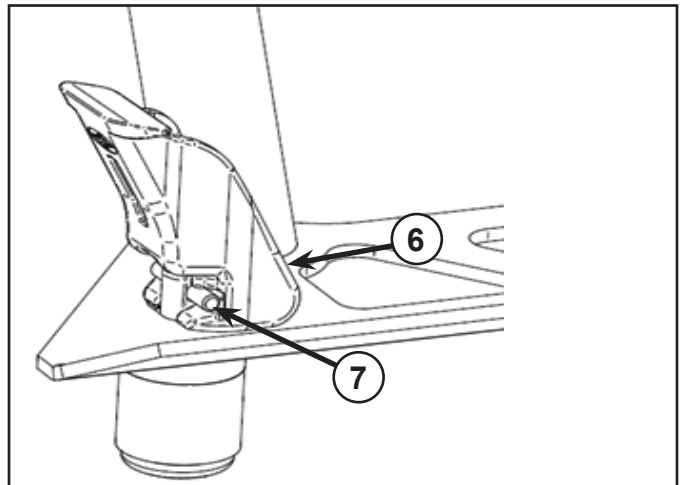
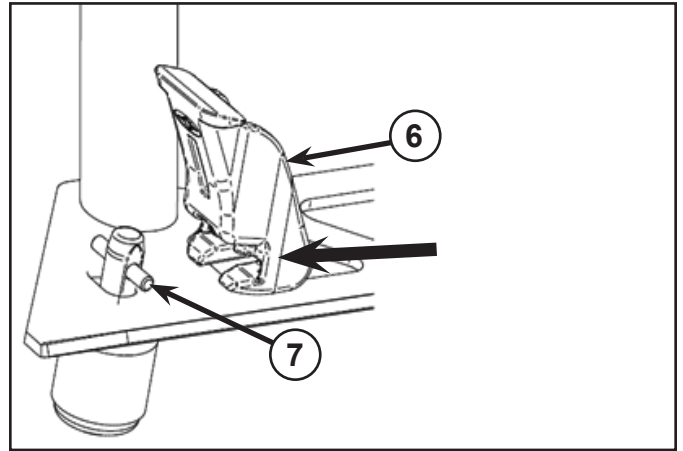

8. Turn handle (6) downward to lock pin (7) into handle. The handle should be firmly secured to the Lock and Ride. Re-open Lock and Ride and proceed to Step 9. See figure.

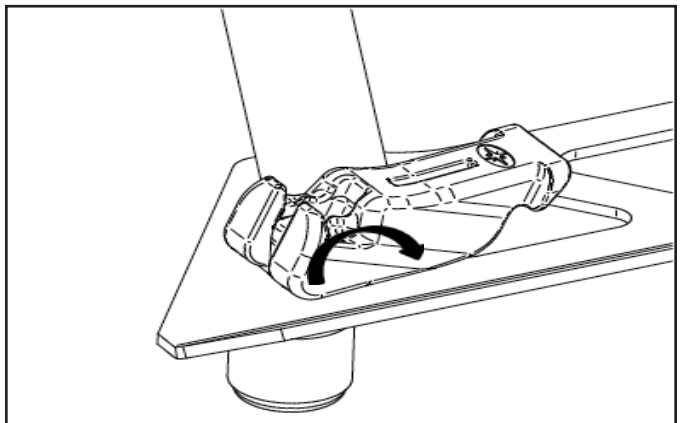

9. Insert front tab of frame in slot (A) of cargo rack as shown in figures.

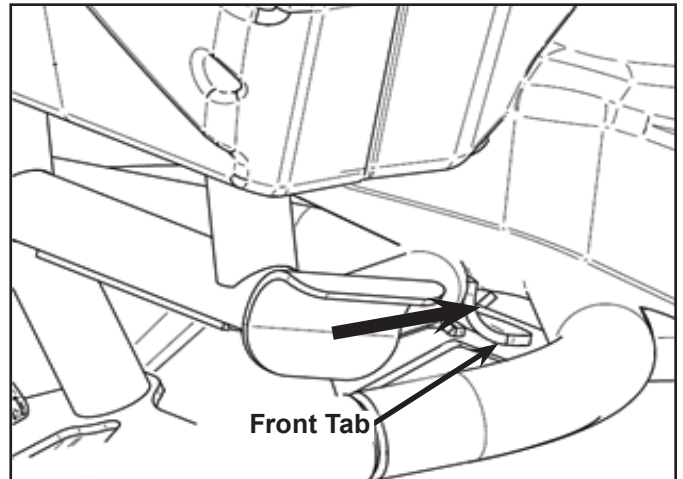
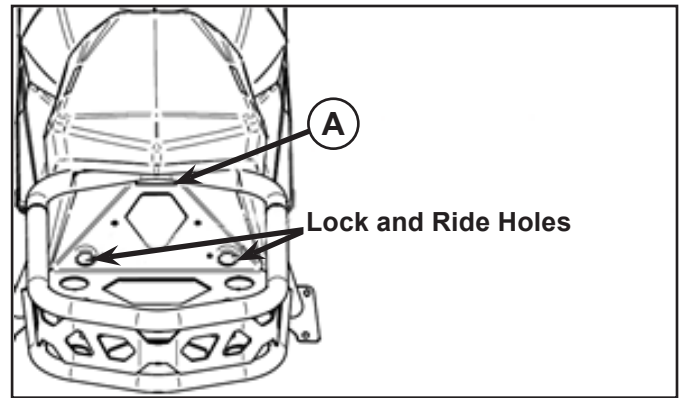

10. Align Lock and Ride assemblies in the holes (B) of the cargo rack and rotate the backrest in place as shown in figure and refer to Step 9 associated figure.

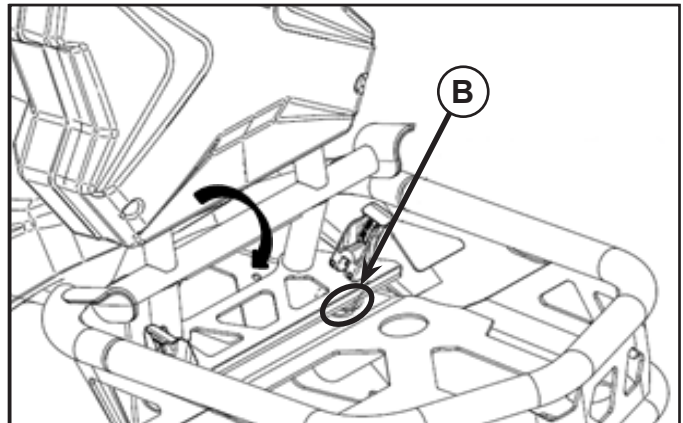

11. Close both handles (6) of the Lock and Rides towards the inside as shown in figure.

12. Verify that the backrest is firmly secured.

