

PASSENGER FOOTREST KIT



P/N 2883571

APPLICATION

Verify accessory fitment at Polaris.com.

BEFORE YOU BEGIN

Read these instructions and check to be sure all parts and tools are accounted for. Please retain these installation instructions for future reference and parts ordering information.

KIT CONTENTS

This Kit includes:

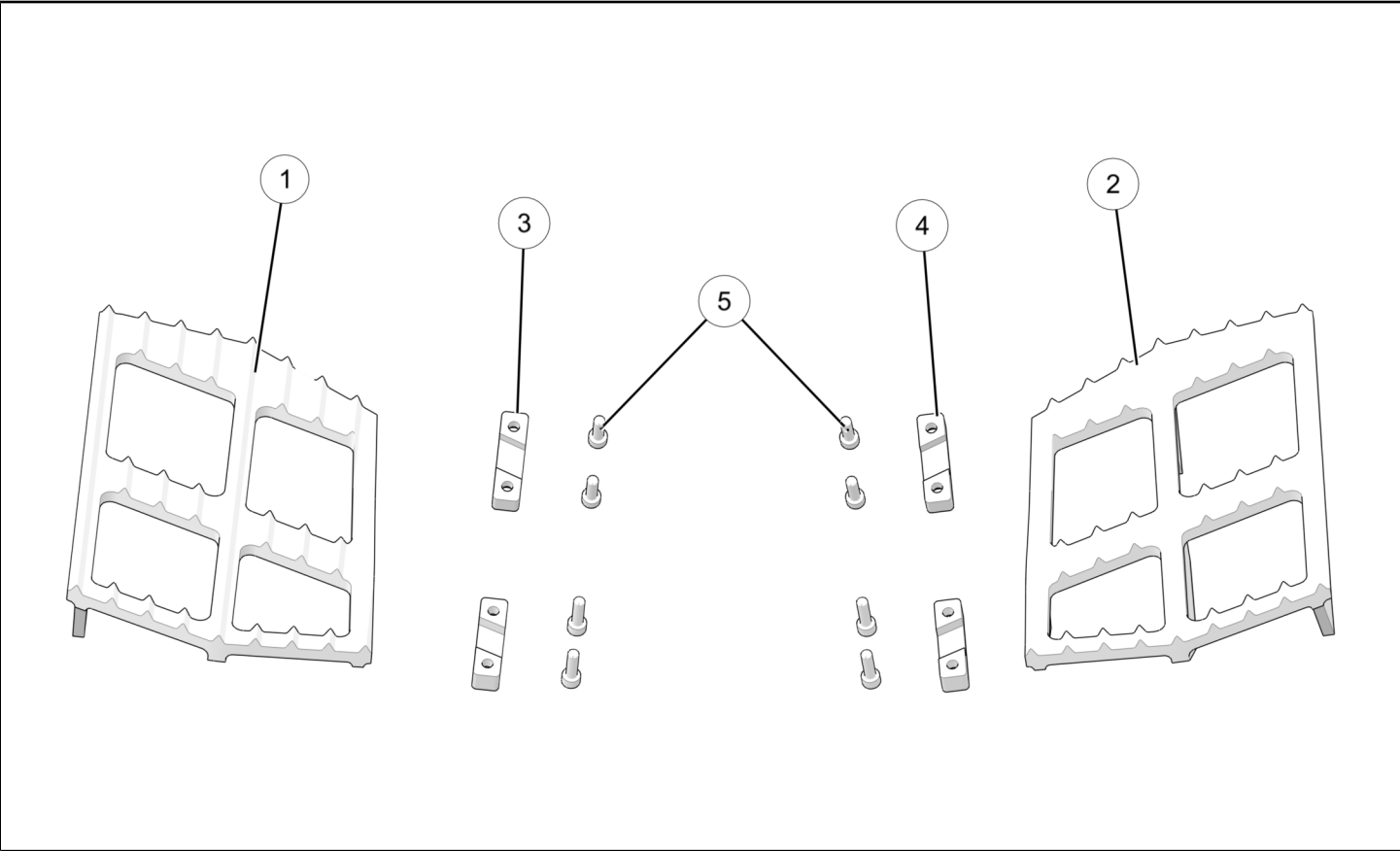

REF	QTY	PART DESCRIPTION	PART NUMBER
1	1	Passenger Footrest - RH	5142313
2	1	Passenger Footrest - LH	5142312
3	2	Lower Mounting Bracket - RH	5142411
4	2	Lower Mounting Bracket - LH	5142410
5	8	Socket Head Screw - M5 X 0.8 X 16	7516610
	1	Instructions	9928800

TOOLS REQUIRED

- Safety Glasses
- Socket Set, Hex Bit, Metric
- Torque Wrench

IMPORTANT

Your Passenger Footrest Kit is exclusively designed for your vehicle. Please read the installation instructions thoroughly before beginning. Installation is easier if the vehicle is clean and free of debris. For your safety, and to ensure a satisfactory installation, perform all installation steps correctly in the sequence shown.

ASSEMBLY TIME

Approximately 6 minutes

NOTE

Additional time may be required for optional steps, or to accommodate other installed accessories.

INSTALLATION INSTRUCTIONS

CAUTION

BEFORE STARTING INSTALLATION, always ensure vehicle is on a flat stable surface and is properly secured to avoid accidental tipping or other movement in order to prevent personal injury and/or damage to equipment. If applicable, turn key to "OFF" position and remove from vehicle.

1. Place Right hand passenger footrest ① into the indicated position. The mounting holes in the bottom of the footrest should be positioned on each side of the tunnel support ribs as shown.

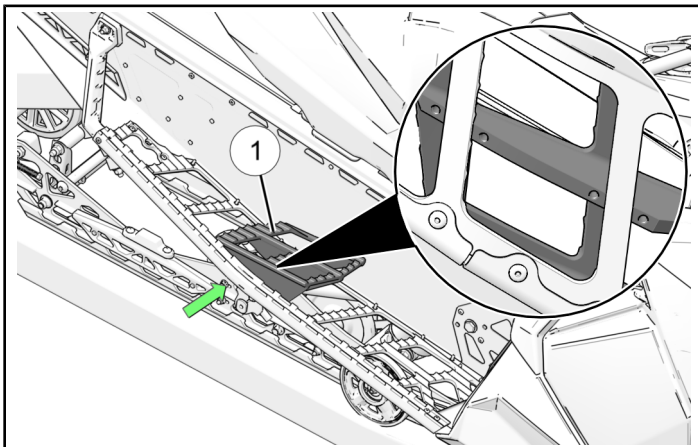

2. Install the right hand lower mounting brackets ③ using the supplied fasteners ⑤. Start all fasteners by hand then torque to specification provided.

NOTE

Right and left hand lower mounting brackets are different.

TORQUE

65 in. lbs. (7.3 Nm)

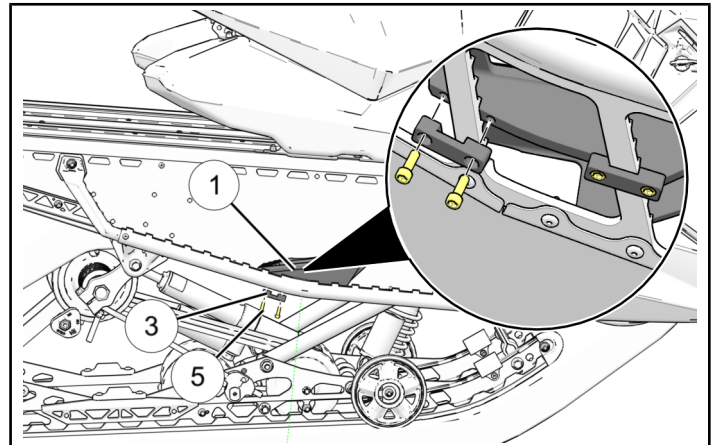

3. Repeat steps 1 and 2 for opposite side.
4. Check to make sure all tools are accounted for and all necessary steps have been completed.

FEEDBACK FORM

A feedback form has been created for the installer to provide any comments, questions or concerns about the installation instructions. The form is viewable on mobile devices by scanning the QR code or by clicking [HERE](#) if viewing on a PC.

FEEDBACK FORM

